



We create chemistry

Pest Control Solutions

Product Catalog





Introduction	2
Innovations	4
Pest Solutions	
Ants	7
Bed Bugs	8
Fleas	8
German Cockroaches	9
Occasional Invaders	10
Flies	10
Termites	11

TABLE OF CONTENTS

Products	
PT® 565 Plus XLO Pressurized Contact Insecticide PT P.I.® Pressurized Contact Insecticide PT Alpine® Pressurized Insecticide PT Phantom® II Pressurized Insecticide PT Fendona® Pressurized Insecticide PT 221L Pressurized Insecticide PT Microcare® CS Pressurized Insecticide System III® Applicator PT Alpine Pressurized Fly Bait PT Alpine Flea & Bed Bug Pressurized Insecticide PT Alpine Foam Ready-to-Use Insecticide PT Ultracide® Pressurized Flea Insecticide PT Wasp-Freeze® II Wasp & Hornet Insecticide PT Tri-Die® Pressurized Insecticide PT Clear Zone® III Metered Pyrethrin Spray PT Pro-Control® Formula 2 Total Release Pressurized Insecticide	Pressurized Insecticides Pages, 12-17
Advance® Brand Ant Baits Siesta® Insecticide Fire Ant Bait MotherEarth Granular Scatter Bait Alpine Cockroach Gel Bait Rotation 1 & 2 Reservoirs Avert® DF Dry Flowable Cockroach Bait Selontra® Rodent Bait	Baits Pages, 18-19
Alpine D Dust Insecticide Tri-Die® Silica & Pyrethrin Dust PT Tri-Die Pressurized Dust Insecticide	Dusts Page, 22
Fendona CS Controlled Release Insecticide PermaCap® CS Controlled Release Insecticide Termidor® SC Termiticide/Insecticide Phantom Termiticide-Insecticide Alpine WSG Water Soluble Granule Insecticide	Dilutables Pages, 23-25
Instant Soap 'n Water® Foaming Cleanser Allure® MD Mating Disruption System for Stored Product Moths Allure Stored Product Moth Kit Bio-5 Drain Cleaner by BASF 960 Fruit Fly Monitor	Misc. Pages, 26-27
Termidor HE High-Efficiency Termiticide Termidor SC Termiticide/Insecticide Termidor 80 WG Termiticide/Insecticide Termidor Foam Termiticide/Insecticide Termidor HP II High Precision Termiticide Phantom Termiticide-Insecticide	Termiticides Pages, 28-31
Trelona® ATBS Annual Bait Stations StationSeeker™ Advance® Termite Bait Stations Termite Baiting Components	Termite Bait Systems Pages, 32-33

With a powerful portfolio and an expert team, BASF has proudly supplied the Pest Control industry with cutting-edge chemistries and reliable support for decades. We strive each day to deliver on our position as the most valued manufacturer, earning your trust as the partner you rely on for solutions, tools and resources.



Efficiency

Reduce time and labor

Less time and labor makes your job easier and your business more profitable. The BASF portfolio of general pest control and termite control solutions are formulated to help you gain operational efficiencies, which can help grow your business.



Support

Commitment to the profession

Our partnerships are an important part of our work for the future state of the pest control industry. We thank our valued partners, including NPMA, state pest associations, distributors, trade publications and more that offer vital support and educational resources to the industry at large.



Reliability

Effective products you can count on

Getting the job done right the first time frees your business for more jobs and increases customer satisfaction. BASF pest control solutions combine effective products with proven practices for reliable results you can trust.



Innovation

We are committed to a future that is sustainable for the planet and profitable for your business. Through ongoing R&D and continuous efforts to advance our offerings, we invest in the innovations that move you and the industry forward.

COMING IN 2025



Ridesco WG

Insecticide

A.I. 20% Dinotefuran and 10% Alpha-Cypermethrin

- Quick release formulation allows active ingredients to hit pests immediately
- Swiftly reduces pest populations
- Two proven active ingredients impact different physiological pathways
- Dry formulation with a flexible label and one simple rate

Prelontra™ Rodent

Monitoring Soft Block

- Non-toxic formulation monitors the activity of rodent infestations to help PMPs determine if, when and where Selontra® Rodent Bait treatments are needed as the next-and last-step in eliminating an infestation
- Target rodents familiarized with Prelontra Rodent Monitoring Soft Block will quickly adapt to Selontra Rodent Bait
- Each soft block is wrapped in perforated film that allows natural odors to escape while providing protection from slugs and snails
- Central hole in each block for easy securement



ANTS



The Problem

Ants are the number one reason homeowners call a pest management professional. Given this reality, ants have a particular importance not only as a frequently encountered pest control challenge, but quite often as the foundation of your ongoing relationship with a customer.

Due to their complex social structures, foraging and nesting habits and more, ants can be quite difficult to control. The cost of failure, at best, will be callbacks, wasted time and resources. At worst, it will be the loss of a potential profitable, long-term customer.

The Solution

The BASF Absolute Ant Control Guide gives you everything you need to confidently control ant problems, minimize callbacks and establish longstanding customer relationships. It employs a multi-layer, inside-out approach that maximizes the genuine transfer effect¹ of **Termidor® SC** termiticide/insecticide while taking advantage of the broad label of **Alpine® WSG** water soluble granule insecticide.



For more information see **BASF Absolute Ant Control**

The Products

Layer 1: Outside (Off-Structure)

Treating away from the structure reduces the pressure around the structure itself. This aids in control and helps prevent newly invading colonies from setting up close to the house.

- **Alpine WSG** water soluble granule insecticide
- **Advance®** brand ant baits
- **Siesta®** insecticide fire ant bait

IPM techniques and industry-leading technical support complete the solution and help make your ant program a more powerful source of new business opportunities and profit.

Layer 2: Outside (Exterior Foundation)

Termidor SC termiticide/insecticide creates a potent treated zone of non-repellent protection around and on the home. Ants pass through it and transfer the active ingredient to nest mates through routine social contact.

- **Termidor SC** termiticide/insecticide¹

Layer 3: Inside

Alpine WSG water soluble granule insecticide expands the treatment zone inside the structure, without the risk of "budding" or "lock-in" that can occur with repellent insecticides. **Advance** brand ant baits provide targeted ant bait options for different ant species and use sites. **PT Alpine®** pressurized insecticide delivers quick, convenient, and accurate treatment to ant scouts, trails, or hotspots in the home.

- **Alpine WSG** water soluble granule insecticide²
- **Advance** brand ant baits
- **PT Alpine®** pressurized insecticide

¹ 2003, B. Wiltz and D. Suiter, University of GA

² Use **Phantom termiticide-insecticide** in NY for indoor applications because **Alpine WSG** water soluble granule insecticide's NY registration for indoor use is limited to crack and crevice and spot treatment.

BED BUGS



The Problem

Few pests pose control challenges as complex as bed bugs. Hard to find, persistent, and pervasive, bed bugs require considerable professional expertise and significant homeowner cooperation. As if that isn't enough, research indicates that bed bug strains showing resistance to pyrethroid insecticides are widespread in the United States. Factor in repellency-related problems associated with pyrethroids, and it's clear: a smarter approach to controlling bed bugs is sorely needed.

The Solution

The BASF Better Bed Bug Control protocol is based on the latest research and effective strategies utilizing breakthrough materials with significant advantages over residual pyrethroids. With this treatment guide, steps can now be taken to kill existing bed bugs or prepare a room for the event of bed bug infestations in a way that significantly reduces the likelihood that an infestation will take hold and spread.

The Products

- **PT® Phantom® II** pressurized insecticide kills pyrethroid resistant and non-resistant bed bugs
- **Phantom** termiticide-insecticide for long-lasting control of even pyrethroid-resistant bed bugs including newly hatched nymphs
- **Alpine® D** dust insecticide for bed bug-prone voids even in sensitive accounts
- **PT Alpine Flea & Bed Bug** pressurized insecticide for upholstered furniture and carpets
- **Alpine WSG** water soluble granule insecticide

FLEAS



The Problem

Once among the top reasons for calls to PMPs, flea problems appeared to decline significantly toward the end of the 20th century. With improved flea control products and the introduction of on-animal products, homeowners began relying more on veterinarians than PMPs for flea control.

However, today flea business is up throughout the United States, as compared to just a few years ago. Homeowner complacency in treating their pets and an increase in urbanization, which has displaced wildlife such as raccoons, skunks, and opossums may well have been factors in this flea resurgence.

Whatever the cause, fleas are a problem no PMP should be ill-prepared to effectively and efficiently control.

The Solution

The BASF flea control solution is designed to help you reliably control fleas and minimize technician time and labor as well as homeowner inconvenience. It combines a strategic inspection and application plan with pressurized technology and advanced products for quick knockdown and residual control.

The Products

- **PT Alpine Flea & Bed Bug** pressurized insecticide for quick knockdown and in as little as 30 minutes
- **PT 565 Plus XLO** pressurized contact insecticide as a direct contact and space treatment
- **Alpine WSG** water soluble granule insecticide for broadcast treatment outdoors
- **PT Ultracide®** pressurized flea insecticide kills hatching eggs for up to seven months
- **PT Pro-Control® Formula 2** total release pressurized insecticide provides a quick and thorough means of treating whole areas for flea infestations regardless of the infestation size.

GERMAN COCKROACHES



The Problem

German cockroaches are pervasive, elusive, and prolific. They are also associated with numerous pathogenic organisms, a source of human allergens, and an unsightly prompt for assumptions of poor sanitation. Obviously, their presence anywhere food is processed, stored, or served is unacceptable. Controlling German cockroaches in these environments, however, can prove quite challenging. They travel easily on deliveries, reproduce quickly, and prefer to live inside difficult to access cracks, crevices and voids. In addition, some German cockroach strains are resistant to some common insecticides, and others have developed feeding aversions to some bait formulations.

These challenges are compounded by common control methods that employ inadequate inspection and overreliance on a single product or application method. Clearly, the time has come for a smarter solution for controlling German cockroaches.

The Products

- **Alpine®** cockroach gel bait rotation 1 and 2 reservoirs for an attractive and reliable gel bait rotation system
- **Avert® DF** dry flowable cockroach bait reaches void areas that gels can't reach
- **PT® P.I.®** pressurized contact insecticide for flushing and contact action
- **PT Phantom® II** pressurized insecticide and **Phantom** termiticide-insecticide for long-lasting control and resistance management
- **PT Alpine** pressurized insecticide is non-repellent and can be used with baits
- **Alpine WSG** water soluble granule insecticide for non-repellent control and resistance management as part of a rotation program with products containing active ingredients with different modes of action
- **PT Pro-Control® Formula Plus** total release pressurized insecticide can be used in food-handling areas and treats up to 5,000 cubic feet
- **PT Tri-Die®** pressurized dust insecticide Ideal product for voids where kill and exclusion of cockroaches are important
- **PT Fendona®** pressurized insecticide for quick knockdown of cockroaches



For more information see
BASF Complete Cockroach Control

The Solution

The BASF Complete Cockroach Control Guide is based on the latest research and an IPM approach along with cutting edge products and strategies to overcome bait aversion, chemical resistance and other control issues. Combine baits with non-repellents for an effective combination program.



OCCASIONAL INVADERS



The Problem

Many PMPs offer comprehensive, general pest control programs that are serviced monthly, bi-monthly or quarterly, primarily for structure exteriors where most pest problems originate. The “occasional invaders” behind these problems include millipedes, centipedes, silverfish, crickets, beetles, spiders, wasps, and many other pests. Factor in regional pests like cluster flies, scorpions, and fire ants, and it’s clear that occasional invaders hold significant business and revenue potential. Without the right combination of products and treatment approaches required to deal with all of these pests, that revenue potential may never be fully realized. That’s where the BASF occasional invaders control solution comes in.

The Solution

The BASF occasional invaders control solution provides PMPs with a comprehensive toolbox of products that make optimum use of both technician time and superior control materials. It gives you the flexibility to control a broad spectrum of pests with a simple process incorporating IPM treatments for active conditions, a well thought out preventive strategy, and the scheduling and efficiency advantages of perimeter-based service.

FLIES



The Problem

Flies in and around commercial food areas annoy customers and prompt the assumption of unsanitary conditions. Flies in poultry and livestock operations reduce weight gain and productivity of animals, compromise biosecurity and serve as vectors for Salmonella, *E. coli*, *Cryptosporidium*, Listeria and more.

The common misconception that fly control can be accomplished easily by installing an Insect Light Trap has created a tendency to overlook the importance of a comprehensive fly control program.

Effective, long-term fly control requires an integrated approach that includes identifying threats, locating breeding sites and access points, and employing the right environmental, procedural, mechanical, and chemical tactics.

The Solution

The BASF fly control solution is designed to help you create a comprehensive, on-going fly control program that addresses flies at their source and provides immediate relief from adult flies. The remedial actions and preventive components of this two-pronged fly management program help your customers better understand and appreciate the value of the service you are providing.

The Products

- **Fendona® CS** controlled release insecticide and **MotherEarth** granular scatter bait¹ hold up in harsh environments and offer residual control of a broad range of frequently encountered pests
- **Alpine® D** dust insecticide for treatments in voids
- Check out **Alpine WSG** water soluble granule insecticide for brown marmorated stink bugs and kudzu bugs
- **PT® Fendona** pressurized insecticide and **PT Wasp-Freeze® II** wasp & hornet insecticide

¹2007, S. Sims and L. Reed, Whitmire Micro-Gen Research Labs, MO

The Products

- **PT Alpine** pressurized fly bait is a ready-to-use fly bait spray with quick knockdown
- **Alpine WSG** water soluble granule insecticide is non-repellent and labeled for surface applications and broadcast treatments; indoors and outdoors
- **Bio-5 drain cleaner** by BASF biological action breaks down organic matter where flies breed
- **960 fruit fly monitor** attracts and captures pesky fruit flies and aids in monitoring population levels
- **PT 565 Plus XLO** pressurized contact insecticide and **PT P.I.** pressurized contact insecticide for food-handling areas
- **PT Fendona** pressurized insecticide offers quick knockdown and pinpoint accuracy

TERMITES



The Problem

Termites hold a unique position in the world of professional pest control. Every year, they cause several billions of dollars in damage to properties in the United States. Without the efforts of PMPs, that number would be much higher. Given the risk termites give virtually every homeowner a compelling reason to use professional pest control services, both curatively or preventively.

The Solution

The BASF Total Termite Control protocol is designed to help you profit from offering termite control and preventative solutions with virtually any customer, construction type, and challenging situation you encounter. This protocol will introduce you to the products, application methods, and strategies that will help you continue to succeed and grow your termite business for many years to come.

The Products

- **Termidor® HP II** termiticide combines four steps (mixing, trenching, applying, and back covering) in one injection
- **Termidor HE** high-efficiency termiticide reduces treatment time 50% vs. conventional applications
- BASF termite monitoring and active bait systems
 - **Trelona® ATBS** annual bait stations
 - **Advance®** termite bait stations
- **Termidor Foam** termiticide/insecticide as a ready-to-use foam treatment for harborages, galleries and voids
- **Termidor SC** termiticide/insecticide is the industry standard, with a flexible label that includes general pests
- **Phantom®** termiticide-insecticide offers highly effective, long-residual control



Contact

Pressurized contact insecticides enhance inspections with excellent flushing action and knockdown. Their non-residual nature even makes them great choices for everyday use within sensitive accounts, including commercial kitchens. BASF is proud to have assembled one of the most effective and popular collections of pressurized contact insecticides.



PT® 565 Plus XLO

Pressurized Contact Insecticide

System III
Compatible

A.I. 0.5% Pyrethrins, 1% PBO,
1% MGK-264
Packaged 12 x 14 oz.

- Excellent for use during inspections
- Registered for use in food handling areas



PT P.I.®

Pressurized Contact Insecticide

System III
Compatible

A.I. 0.5% Pyrethrins, 4% PBO
Packaged 12 x 14 oz.

- Fast drying formulation
- Excellent for space treatment
- Registered for use in food handling areas

Non-Repellent

Non-Repellent insecticides are undetectable to pests (do not scatter or disperse them throughout an account) and are excellent choices to use in conjunction with baits as they do not affect palatability. Excellent for use in rotation for resistance management, these non-repellents are staples in the fight against a broad range of pests.



PT Alpine®

Pressurized Insecticide

System III
Compatible

A.I. 0.5% Dinotefuran
Packaged 12 x 14 oz.

- Reduced risk active ingredient*
- Registered for use in food handling areas
- A great rotational partner in a non-repellent program

*The active ingredient dinotefuran has been granted Reduced Risk status for use in public health and food handling areas by the EPA.



PT Phantom® II

Pressurized Insecticide

System III
Compatible

A.I. 0.5% Chlorfenapyr
Packaged 12 x 14 oz.

- Non-repellent aerosol with broad spectrum control including bed bugs, ants and cockroaches
- Registered for use in food handling areas

Note: Before using these products, check with your state's Department of Agriculture for any restrictions.

Repellent

These insecticides include trusted, go-to products effective on a wide range of pests in a long list of locations, and they're simple to use and easy to apply. With multiple formulations and active ingredients to choose from, you're sure to find the right solution for every job.



PT® Fendona®

Pressurized Insecticide

System III
Compatible

A.I. 0.05% Alpha-Cypermethrin
Packaged 12 x 14 oz.

- Perfect combination of quick knockdown of key pests and residual for house flies and bed bugs
- Pinpoint accuracy
- Registered for use in food handling areas



PT 221L

Pressurized Insecticide

System III
Compatible

A.I. 0.05% Lambda-Cyhalothrin
Packaged 12 x 14 oz.

- Effective against common household and commercial pests including ants, bed bugs, scorpions, spiders, ticks and cockroaches
- Pinpoint accuracy
- Very economical



PT Microcare® CS

Pressurized Insecticide

A.I. 0.5% Pyrethrins, 2.5% PBO
Packaged 12 x 14 oz.

- Flexibility of a ready-to-use insecticide
- Capsule suspension extends active life of natural pyrethrum
- Pinpoint accuracy
- Registered for use in food handling areas

Note: Before using these products, check with your state's Department of Agriculture for any restrictions.

System III®



Work Smarter with PT + System III Applicator

The BASF aerosol lineup works even more effectively and efficiently when paired with the **System III** applicator. The System III applicator is designed to make pest management professionals even better at what they do with precise, easy-to-deliver applications of compatible PT Brand products into the most hard-to-reach areas. Plus, its modern look elevates the professional image of PMPs while the state-of-the-art design increases the practicality and profitability of compatible PT pressurized insecticides.

To learn more about the System III applicator and all of the available PT brands, visit pestcontrol.basf.us.

The System III applicator is designed exclusively for BASF pressurized products labeled “For use with the System III”. BASF makes no claims regarding the use of the System III with other aerosol products.

System III Maintenance And Repair

If System III Will Not Spray

- 1.The shut-off valve handle (11) may be in the OFF position
 - Move the shut-off valve handle to the ON position
- 2.The pressurized can may be empty
 - Replace empty can with full one
- 3. The white valve stem (3) in the gun may be clogged
 - Replace the stem spring gasket (3) with new components found in every case of System III compatible products
 - Tighten the gun cap (2), ensuring the gun clip (4) is pushed down into a seated position not to interfere with the gun cap seal

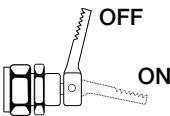

If Leak Occurs

- 1. If there is a leak in the hose...
 - Remove the spring guard (8) from the nut and ferrule (7) by sliding it along the hose
 - Remove the nut and ferrule (7) from the female compression fitting and swivel (6, 9)
 - Cut the hose (14) above the hole
 - Place new nut and ferrule at hose end
 - Re-attach the spring and fitting
 - Re-assemble the System III and test
- 2. If leaking occurs at the actuator or stem gasket...
 - If actuator (1) leaks, first replace actuator.
 - If actuator (1) still leaks, be sure it is seated securely on the white valve stem (3)
 - If white valve stem (3) leaks after use, it may be necessary to re-seat the stem to force the stem gasket (3) to flex differently
- 3. If there is a leak at the gun cap...
 - Check to make sure the gun clip (4) is positioned properly
 - Push the gun clip (4) down into a better-seated position so that it does not interfere with the gun cap seal
 - Continue to put pressure on the gun clip (4), holding it in place while you tighten the gun cap (2)

Preventative Maintenance Tips:

- 1. Replace stem / spring / gasket assembly weekly (3)
- 2. Purge pressure from hose after each account service (11)
- 3. Replace actuator cap (1) weekly
- 4. Store with valve in off position
- 5. Avoid damage to unit by storing securely in vehicle

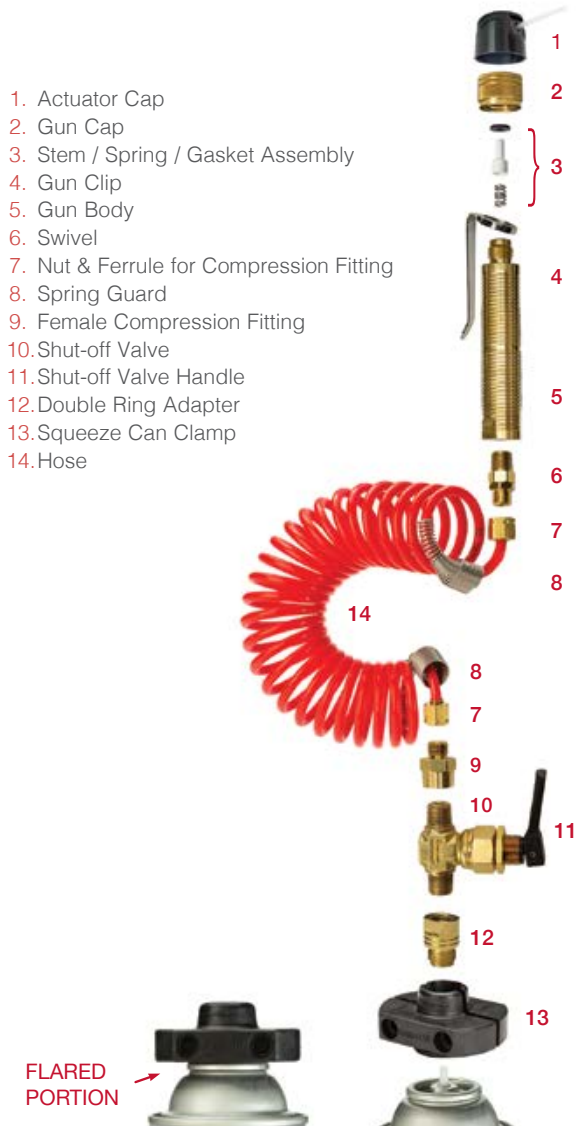

System III Pressurized Products	Void Injector		Applied with System III			Size	Signal Word	Food Handling	EPA Reg. #
	Sec/Oz	Sec/Can	Sec/Oz	Sec/Can	Additional Seconds				
PT® 221L Pressurized Insecticide	20	350	28	481	37%	14 oz.	C	Yes	499-473
PT 565 Plus XLO Pressurized Contact Insecticide	17	340	28	567	67%	14 oz.	C	Yes	499-290
PT Alpine® Pressurized Insecticide	17	340	28	567	67%	14 oz.	C	Yes	499-531
PT Fendona® Pressurized Insecticide	15	266	30	518	51%	14 oz.	C	Yes	499-569
PT P.I.® Pressurized Contact Insecticide	25	450	36	659	46%	14 oz.	C	Yes	499-444
PT Phantom® II Pressurized Insecticide	20	350	28	481	37%	14 oz.	C	Yes	499-548

C = Caution

Note: Before using these products, check with your state's Department of Agriculture for any restrictions.



Specialty

Many pest infestations are best controlled using highly specialized product formulations intended for specific situations. As a leader in product formulation technology, BASF provides the professional pest management industry with a wide variety of innovative specialty tools so you always have the solution you need.

PT® Alpine®
Pressurized Fly Bait



A.I. 1% Dinotefuran
Packaged 6 x 16 oz.

- Ready-to-use fly bait spray
- Quick knockdown
- Versatile label directions include residential, commercial, and event uses
- Proven attractancy for up to 30 days

PT Alpine Flea & Bed Bug
Pressurized Insecticide



A.I. 0.25% Dinotefuran, 0.10%
Pyriproxyfen, 0.05% Prallethrin
Packaged 12 x 14 oz.

- Kills adult fleas for up to 30 days
- Reduced risk active ingredient*
- Label includes bed bugs and ticks

*The active ingredient dinotefuran has been granted Reduced Risk status for use in public health and food handling areas by the EPA.



For more information see
BASF PT Brand Pressurized
Portfolio brochure

PT Alpine Foam
Ready-to-Use Insecticide



A.I. 0.025% Dinotefuran
Packaged 20 oz.

- Reduced risk active ingredient*
- Non-repellent foam for termites and ants
- Rapidly expands generating a dry foam; 1 ounce produces approximately 1 quart of foam
- Highly effective on ants known for interior infestation as well as foraging carpenter ants

*The active ingredient dinotefuran has been granted Reduced Risk status for use in public health and food handling areas by the EPA.

PT® Ultracide®
Pressurized Flea Insecticide



A.I. 0.05% Pyrethrins,
0.4% Permethrin, 0.1% Pyriproxyfen,
0.4% MGK-264
Packaged 12 x 14 oz.

- No mixing, ready-to-use
- Prevents re-infestation of fleas for up to seven months
- Low odor formulation
- Treats 1,820 square feet

PT Wasp-Freeze® II
Wasp & Hornet Insecticide



A.I. 0.1% Prallethrin
Packaged 12 x 14 oz.

- Kills wasp and hornets on contact
- Jet spray kills from 15 feet away

PT Tri-Die®
Pressurized Dust Insecticide



A.I. 0.6% Pyrethrins, 8% Amorphous
Silica, 4.8% PBO
Packaged 12 x 8 oz.

- Convenient ready-to-use, pressurized insecticide dust
- Approved for use in food handling establishments

PT Clear Zone® III
Metered Pyrethrin Spray



A.I. 1% Pyrethrins, 5% PBO
Packaged 6 x 6.25 oz.

- Repellency of flying insects
- 6,000 cubic feet coverage
- Fits most battery operated metered dispensing devices

PT Pro-Control®
Formula 2 Total Release Pressurized Insecticide



A.I. 0.5% Pyrethrins, 4% PBO
Packaged 6 x 6 oz.

- Versatile contact insecticide
- Labeled for use in commercial food handling areas and restaurants/animal housing
- Great choice for treatment of: cockroaches, flies, stored product pests, spiders, ticks, wasps

Note: Before using these products, check with your state's Department of Agriculture for any restrictions.

Note: Before using these products, check with your state's Department of Agriculture for any restrictions.

Ants are among the leading culprits driving homeowner callbacks. BASF offers the **Advance**® line of targeted ant baits which eliminates even the most challenging ant species through its multiple attractants, delivery methods and active ingredients.

Advance 360A Dual Choice

Ant Bait Stations



A.I. 0.011% Abamectin
Packaged 18 pk/box, 4 boxes/cs.

- Professional ant bait station with two food choices to appeal to multiple ants
- Works well on Pharaoh and a variety of nuisance ants
- Contains a protein blend and carbohydrate/oil blend in separate compartments
- Labeled for indoor and outdoor

Advance 375A

Granular Ant Bait



A.I. 0.011% Abamectin
Packaged 8 oz., 2 lbs.

- Contains a mix of grit sizes to take on many species of pest ants
- Universal ant bait formula
- Labeled for indoor and outdoor

Advance

Granular Carpenter Ant Bait



A.I. 0.011% Abamectin
Packaged 8 oz., 2 lbs.

- Large grit size with proprietary blend of attractants
- Best choice for many difficult to control ants
- Labeled for indoor and outdoor

Siesta®

Insecticide Fire Ant Bait



A.I. 0.063% metaflumizone
Packaged 15 lbs. and 25 lbs.

- Large economical 25 lb. bag
- Delivers fast and long-lasting control of native and imported fire ants
- Once ingested, **Siesta** causes feeding and stinging cessation within 24 hours, increased levels of immobility, and death within 72 hours*
- Workers take the bait back to the colony which is then digested and shared with the queen(s) leading to the elimination of the colony.

*2006, J. Cook, Sam Houston State Univ., TX

MotherEarth

Granular Scatter Bait



A.I. 5% Boric Acid
Packaged 4 lbs., 40 lbs.

- For preventive and curative treatment of ants, cockroaches and other occasional invaders
- Formulated to provide long-lasting efficacy
- Labeled for indoor and outdoor use

Note: Before using these products, check with your state's Department of Agriculture for any restrictions.

Note: Before using these products, check with your state's Department of Agriculture for any restrictions.

Cockroaches can be tough to control. Chemical resistance, behavioral aversion, poor housekeeping and other issues all play a part. Baits are often the best solution. Placed in cracks, crevices and voids, they reach roaches where they live and breed. BASF offers a wide range of cockroach baits to meet your cockroach control needs.

Alpine®

Cockroach Gel Bait Rotation 1 & 2 Reservoirs



A.I. 0.5% Dinotefuran
Packaged 30 g. reservoirs

- Reduced risk active ingredient*
- Attractive: Both bait matrices appeal to gel-bait-averse and non-gel-bait-averse cockroaches
- Fast-acting: Both baits contain the active ingredient, dinotefuran, which begins killing cockroaches within minutes after exposure to bait
- Reliable: This rotation system guarantees different food ingredients in each formulation
- For optimal aversion management, rotate these formulations every six months and use the BASF Complete Cockroach Control Protocol

* The active ingredient dinotefuran has been granted Reduced Risk status for use in public health and food handling areas by the EPA.

Avert® DF

Dry Flowable Cockroach Bait



A.I. 0.05% Abamectin
Packaged 30 g. tubes

- Reaches void areas gels often can't reach
- Kills roaches where they live and breed
- Remains effective for more than 22 weeks after initial treatment
- No-aversion formulation

Selontra®

Rodent Bait



A.I. 0.075% Cholecalciferol
Packaged 8-lb. pail

- Non-anticoagulant solution delivers fast colony kill, even with resistant rodents
- Stop-feed action of the active ingredient cholecalciferol means rodents only eat the lethal dose¹ leading to greater bait availability and shorter baiting cycles
- Low risk of secondary poisoning to non-target birds and mammals²

¹ Prescott, C.V., El-Amin, Vusa, and Smith, R.H. Calciferols and Bait Shyness in the Laboratory Rat. Proceedings of the Fifteenth Vertebrate Pest Conference 1992. Paper 64.

² Erickson, W.; Urban, D. Potential Risks of Nine Rodenticides to Birds and Nontarget Mammals: a Comparative Approach. U.S Environmental Protection Agency; Office of Prevention, Pesticides, and Toxic Substances; Office of Pesticide Programs; U.S. Government Printing Office: Washington, DC, 2004.

Note: Before using these products, check with your state's Department of Agriculture for any restrictions.



Note: Before using these products, check with your state's Department of Agriculture for any restrictions.

Long-lasting protection from pests is best achieved with dust formulations. In some cases, voids treated with dusts do not require additional applications until the dust is removed. BASF offers a wide range of dust products including repellent and non-repellent products and bulk or pressurized delivery.

Alpine® D

Dust Insecticide



A.I. 0.25% Dinotefuran,
95% Diatomaceous Earth
Packaged 3 lbs.

- Reduced risk active ingredient*
- Non-repellent dust for ants, bed bugs and stinging insects
- Broad use label for inside and outside including food handling areas
- Doesn't excite stinging insects

* The active ingredient dinotefuran has been granted Reduced Risk status for use in public health and food handling areas by the EPA.

Tri-Die®

Silica & Pyrethrin Dust



A.I. 1% Pyrethrins, 40%
Amorphous Silica, 10% PBO
Packaged 5 lbs.

- Naturally derived repellent dust with contact kill
- Very stable formulation
- Creates an environment unsuitable for, and repellent to, insects

PT® Tri-Die

Pressurized Dust Insecticide



A.I. 0.6% Pyrethrins, 8%
Amorphous Silica, 4.8% PBO
Packaged 12 x 8 oz.

- Fast-acting residual insecticide dust
- Very repellent
- Unique pressurized formulation enables easy and convenient application of a dust

SmartCap technology is designed to increase field performance, durability and flexibility, while reducing exposure for PMPs. The end result is a long-lasting microcapsule that contains a powerful A.I. within a polymer outer shell.

Fendona® CS

Controlled Release Insecticide



3.0% alpha-Cypermethrin
*Packaged 16 oz., 120 oz.,
30 gal. drum*

- Kills pests fast and is highly effective for months on key labeled pests
- Labeled for more than 60 arthropod pests
- Great for mosquitoes, spiders and scorpions

PermaCap® CS

Controlled Release Insecticide



A.I. 23% Permethrin
Packaged 120 oz.

- Excellent for use in residential accounts
- 30-60 day residual control for lower pest pressure situations*

*2006, A. Appel, Auburn University, AL

Note: Before using these products, check with your state's Department of Agriculture for any restrictions.

Note: Before using these products, check with your state's Department of Agriculture for any restrictions.



Termidor® termiticide/insecticide, **Phantom®** termiticide-insecticide and **Alpine® WSG** water soluble granule insecticide are an unbeatable line-up of products that are undetectable to insects that solve tough pest problems inside and out. **Termidor SC** termiticide/insecticide has long demonstrated its genuine transfer effect technology which has made it the number one choice for controlling ants on the exterior of structures. **Alpine WSG** water soluble granule insecticide's broad list of pests and use sites brings powerful non-repellent pest control inside, outside, and off-structure. **Phantom** termiticide-insecticide controls pests from indoor areas including commercial kitchens with powerful chlorfenapyr, known for its long-lasting efficacy and different mode of action.

Termidor SC

Termiticide/Insecticide



A.I. 9.1% Fipronil
Packaged 20 oz., 78 oz., 2.5 gal.

- The industry standard, with a flexible label
- Controls pests in multiple ways for superior efficacy: either through direct contact or by foraging or trailing over treated surfaces.
- Labeled for ants, spiders, cockroaches and a broad range of other frequently encountered general pests

Phantom

Termiticide-Insecticide



A.I. 21.45% Chlorfenapyr
Packaged 21 oz., 75 oz.

- Highly effective, long-residual non-repellent control
- Broad spectrum control of: ants, roaches, bed bugs, beetles, centipedes, flies, scorpions, wasps, and more
- Labeled for spot and **Crack & Crevice®** applications inside and on outside entry points (doors, windows, eaves, etc.)

Alpine WSG

Water Soluble Granule Insecticide



A.I. 40% Dinotefuran
Packaged 10 g., 200 g., 500 g.

- Label includes surface applications and broadcast treatments, indoor and outdoor treatments, all with no outdoor reapplication interval limitations
- Non-repellent, non-pyrethroid formulation with transfer
- Very effective on ants, bed bugs, German cockroaches, and occasional invaders such as brown marmorated stink bugs and kudzu bugs
- Approved for use in food handling areas
- Reduced risk active ingredient*

* The active ingredient dinotefuran has been granted Reduced Risk status for use in public health and food handling areas by the EPA.

Note: Before using these products, check with your state's Department of Agriculture for any restrictions.



BASF offers non-insecticide solutions, such as monitors that help identify and document potential issues and cleaners that help improve sanitation to better serve your customers.



Instant Soap 'n Water® Foaming Cleanser

Packaged 12 x 9 oz.

- Foaming natural soap cleanser for hands and surfaces
- Has hundreds of uses and smells great
- Convenient to use after every application at job site



Allure® MD Mating Disruption System for Stored Product Moths

Packaged 5 dispensers/pouch,
5 pouches/cs.

- Controls stored product moths through mating disruption with pheromone technology
- Reduces cleanup and shutdown costs associated with traditional treatments
- Continual preventive control strategy
- Great for sensitive accounts



Allure Stored Product Moth Kit

Packaged 24 traps, 24 lures/cs.

- Attracts and traps stored product moths by means of controlled released pheromone
- Excellent evaluation tool to determine the effectiveness of insecticide applications
- Can be placed throughout food processing plants, food warehouses and in other food processing facilities where moth infestations are suspected
- Can also be used in kitchens and pantries of homes to detect and trap stored product moths

Note: Before using these products, check with your state's Department of Agriculture for any restrictions.



Bio-5 Drain Cleaner by BASF

Packaged 12 x 1 qt.

- Multipurpose biological drain cleaner
- Removes decaying organic matter associated with drains. Reduces fly breeding sources in drains.
- Improves drain flow, eliminates odors, reduces pest food sources & breeding sites

Note: Before using these products, check with your state's Department of Agriculture for any restrictions.



960 Fruit Fly Monitor

Packaged 12 traps/box,
4 boxes/cs.

- Ready-to-use trap designed to attract *Drosophila*
- This versatile trap has a patented food grade attractant that readily attracts several species of *Drosophila* including *melanogaster*, *repleta* and *hydei*
- Trap capture is further enhanced by the orange-colored plastic with a specially selected chemical composition
- Engineered with 10-hole venting lid to optimize *Drosophila* exposure to the vapors emitted from the liquid attractant
- The lid is removable for easy monitoring and identification of catch



Termidor® termiticide/insecticide is a revolutionary non-repellent that has consistently proven itself to be the most recognized and effective termite control brand. Since its introduction in 2000, pest management professionals have made **Termidor** termiticide/insecticide America's #1 termite defense product.

Termidor termiticide/insecticide eliminates termites by both ingestion and contact with genuine transfer effect. Termites can acquire a lethal dose by just contacting other nest-mates that have been exposed to the product. The result is 100% control in 3 months or less. **Termidor** termiticide/insecticide's genuine transfer effect helps deliver devastating results to termites while protecting the structure.



A.I. 8.73% Fipronil
Packaged 79 oz., 2.5 gal.

- The number one liquid termiticide on the market
- Breakthrough molecular technology allows for 50% shallower treatment depths, 33% fewer drill holes, 77% smaller trenches and 50% less water to cut treatment time in half
- More than a decade of real-world results protecting homes and structures

Termidor HE is not labeled for use in NY.



A.I. 9.1% Fipronil
Packaged 20 oz., 78 oz., 2.5 gal.

- The industry standard, with a flexible label that includes ants, spiders, and other key pests
- Formulated by the experts at BASF and backed by the industry's strongest pledge
- Long residual, non-repellent control enhanced with genuine transfer effect technology

Termidor SC is not labeled for termite use in NY.



A.I. 80% Fipronil
Packaged 4 WSB/packet,
6 packets/pail

- Formulated as a dry water dispersible granule packaged in water soluble bags (WSB)
- Easy-to-mix formulation
- Each pail makes 600 gallons of finished dilution

Termidor 80 WG is not registered for use in CA or NY



A.I. 0.005% Fipronil
Packaged 6 x 20 oz.

- The same great efficacy you have come to expect from **Termidor** termiticide/insecticide products in a ready-to-use foam formulation
- Works great on termites and ants
- Expansion ratio - 30:1
- Unique formulation has thicker, stronger cell walls that last up to six times longer than other foams

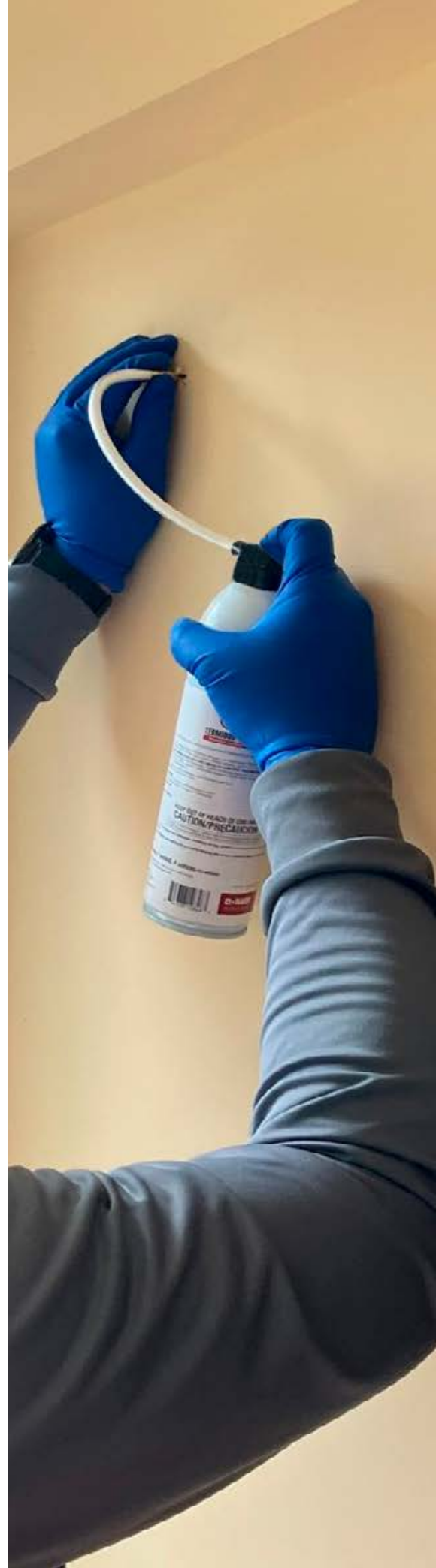

A.I. 8.73% Fipronil
Packaged 1 gal.

- For use with the **Termidor HP** High-Precision Injection System
- Revolutionary termiticide application that allows for little to no drilling of foundation adjacent hard surfaces, like patios, slabs, etc.
- Mixes **Termidor HP II** termiticide at the point of injection
- Injects **Termidor HP II** termiticide creating a uniform hydraulic trenching zone
- The same efficacy you have come to trust from **Termidor** termiticide/insecticide products

Termidor HP is not labeled for use in NY.

Termidor® HP High Precision Injection System



Phantom® Termiticide-Insecticide



A.I. 21.45% Chlorfenapyr
Packaged 21 oz., 75 oz.

- Highly effective, long-residual, non-repellent termite control
- Approved for termite control in NY
- Provides outstanding results on ants, bed bugs and cockroaches

The success of any termite baiting program depends on the ability of termites to locate the station. With its larger station size and design, BASF's termite baiting system is proven to promote faster discovery, faster consumption, and faster colony elimination* that provides peace of mind for you and your customers.

*Not statistically significant at p<0.05; Statistically significant at p<0.10. Data from 2012 University of Delaware, Graduate Research Dissertation.

Trelona ATBS Annual Bait Stations
Annual Inspections, Active Protection

Case Contains: 16 stations pre-loaded with **Trelona** compressed termite bait



- Optimal station design features increased bait-to-soil contact to deliver faster hits
- Low-profile station housing is unobtrusive
- PMPs own the equipment and customer accounts providing ultimate flexibility
- Trelona ATBS annual bait stations offer active protection at the time of installation and has the convenience of an annual inspection
- When using Advance Termite Bait Stations, active is applied only when and where needed after termites activity is confirmed in the station



Trelona®
Compressed Termite Bait

0.5% Novaluron
Packaged 6 cartridges/pack, 8 packs/cs.

- Faster hits¹, faster consumption, faster colony elimination
- 124 grams compressed Puri-Cell bait matrix
- Label with flexible inspection intervals



For fast detection of Trelona and Advance stations with RFID technology, BASF recommends the StationSeeker™ from RFID, Inc. Purchase at www.rfidinc.com

Advance® Termite Bait Stations
The monitoring station termites find faster

Case Contains: 10 stations pre-loaded with termite monitoring base and termite inspection cartridge



Advance®
Termite Monitoring Base (TMB)

Packaged: 100 TMBs/cs.



- Preferred wood with horizontal grooves that allow easy termite access
- Designed for maximum wood-to-soil contact
- Contains 63 grams of wood
- Functions as the aggregation point, where termites enter the TIC

Advance
Termite Inspection Cartridge (TIC)

Packaged: 25 cartridges/bag, 4 bags/cs.



- Used during monitoring phase
- Contains 93 grams of compressed **Puri-Cell®** bait matrix without active ingredient
- Termites will quickly move from the TMB to the TIC because the bait matrix is preferred over wood even

Advance
Concrete Bait Station

Packaged: 18 stations/cs.



- Installs into cored holes
- Fits industry standard portal cap
- Comes pre-loaded with TMB and TBCs
- Two TBCs can also be added from Day One or after confirmed activity

The Spider
Station Access Tool

Packaged: 10 tools/cs.



- Durable and designed to easily open and close the ATBS Station, making a technician's job more productive

Note: Before using these products, check with your state's Department of Agriculture for any restrictions.



¹ Source: 2012 University of Delaware, Graduate Research Dissertation *Not statistically significant at p<0.05; Statistically significant at p<0.10



BASF
26 Davis Drive
Research Triangle Park
NC 27709
USA
pestcontrol.basf.us

Always read and follow label directions.

Before using these products, check with your state's Department of Agriculture for any restrictions. Prelontra, Spider, StationSeeker, and Ridesco are trademarks of BASF, and Advance, Allure, Alpine, Avert, Clear Zone, Crack & Crevice, Fendona, Instant Soap 'n Water, Microcare, PermaCap, Phantom, P.I., Pro-Control, PT, Selontra, Siesta, System III, Termidor, the Termidor logo, Trelona, Tri-Die Ultracide and Wasp-Freeze are registered trademarks of BASF.

© 2024 BASF Corporation.
All rights reserved.
PSS 24-2500
rev. 9/24



We create chemistry